

Angle screw-in unions

with Whitworth thread

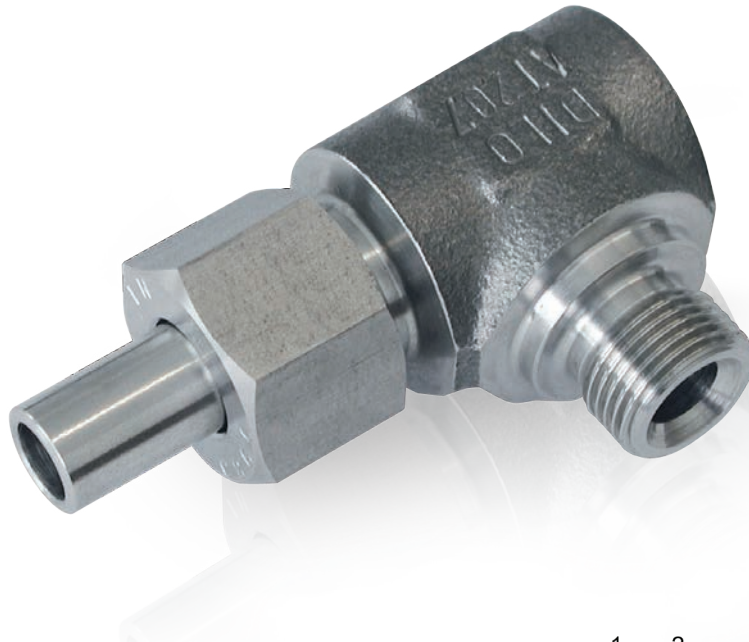

- With weld-on end and screw-in thread
- 90° angle
- Available for tube diameters from DN 3 up to DN 50
- Temperature-resistant from -270 °C up to +500 °C (dependant on the material used)
- Available for pressures up to 1.000 bar on request
- Available in DIN 1.0460, 1.4571 and 1.7335 materials
- Three-part union consisting of weld-on stub, clamping nut und screw-in angle

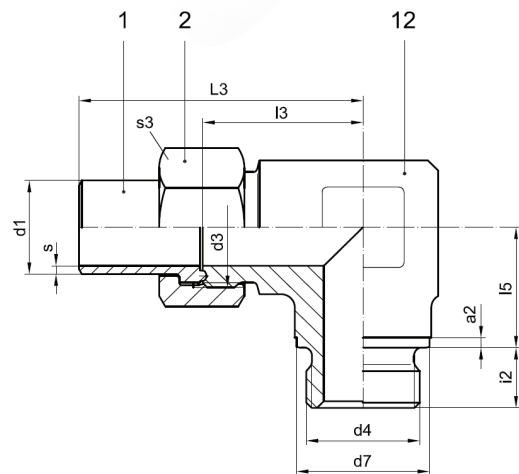

M1BW-G Series for pressures up to PN 100:

| DN | d ₁ | s | d ₃ | d ₄ | d ₇ | L ₃ | l ₃ | l ₅ | i ₂ | a ₂ | s ₃ | Order number | Material number | |
|-----|----------------|------|----------------|----------------|----------------|----------------|----------------|----------------|----------------|----------------|----------------|--------------|-----------------|--------|
| | | | | | | | | | | | | | 1.0460 | 1.4571 |
| 4 | 6 | 1,25 | M 14x1,5 | G 1/8 A | 14 | 42 | 21 | 16 | 8 | 1,5 | 17 | M1BW 4 G | | |
| 6 | 8 | 1,5 | M 16x1,5 | G 1/4 A | 18 | 50 | 27 | 18 | 12 | 2 | 19 | M1BW 6 G | | |
| 8 | 10 | 1,5 | M 18x1,5 | G 1/4 A | 18 | 52 | 27 | 18 | 12 | 2 | 22 | M1BW 8 G | | |
| 10 | 12 | 1,75 | M 20x1,5 | G 3/8 A | 22 | 57 | 30 | 19 | 12 | 2,5 | 24 | M1BW 10 G | | |
| 12 | 15 | 2 | M 22x1,5 | G 1/2 A | 26 | 60 | 31 | 20 | 14 | 3 | 27 | M1BW 12 G | | |
| 16 | 18 | 2 | M 26x1,5 | G 1/2 A | 26 | 64 | 33 | 23 | 14 | 3 | 32 | M1BW 16 G | | |
| 20 | 22 | 2 | M 30x1,5 | G 3/4 A | 32 | 68 | 35 | 28 | 16 | 3 | 36 | M1BW 20 G | | |
| 25 | 28 | 2,5 | M 36x2 | G 1 A | 39 | 84 | 47 | 36 | 18 | 3 | 41 | M1BW 25 G | | |
| 32 | 35 | 2,5 | M 45x2 | G 1 1/4 A | 49 | 94 | 54 | 34 | 20 | 3 | 50 | M1BW 32 G | | |
| 40a | 42 | 3 | M 52x2 | G 1 1/2 A | 55 | 105 | 62 | 40 | 22 | 3 | 60 | M1BW 40a G | | |
| 40 | 44 | 3 | M 56x2 | G 1 1/2 A | 55 | 111 | 68 | 46 | 22 | 3 | 65 | M1BW 40 G | | |
| 50 | 57 | 4 | M 68x2 | G 2 A | 68 | 128 | 80 | 56 | 24 | 3,5 | 75 | M1BW 50 G | | |

M2BW-G Series for pressures up to PN 200:

| DN | d ₁ | s | d ₃ | d ₄ | d ₇ | L ₃ | l ₃ | l ₅ | i ₂ | a ₂ | s ₃ | Order number | Material number | |
|----|----------------|------|----------------|----------------|----------------|----------------|----------------|----------------|----------------|----------------|----------------|--------------|-----------------|--------|
| | | | | | | | | | | | | | 1.0460 | 1.4571 |
| 3 | 6 | 1,5 | M 14x1,5 | G ¼ A | 18 | 48 | 23 | 13 | 12 | 2 | 19 | M2BW 3 G | | |
| 4 | 8 | 2 | M 16x1,5 | G ¼ A | 18 | 52 | 27 | 19 | 12 | 2 | 22 | M2BW 4 G | | |
| 6 | 10 | 2 | M 18x1,5 | G 3/8 A | 22 | 52 | 27 | 19 | 12 | 2,5 | 22 | M2BW 6 G | | |
| 8 | 12 | 2 | M 20x1,5 | G 3/8 A | 22 | 56 | 29 | 21 | 12 | 2,5 | 24 | M2BW 8 G | | |
| 10 | 13,5 | 1,75 | M 22x1,5 | G ½ A | 26 | 62 | 31 | 21 | 14 | 3 | 27 | M2BW 10 G | | |
| 12 | 16 | 2,5 | M 24x1,5 | G ½ A | 26 | 64 | 33 | 25 | 14 | 3 | 30 | M2BW 12 G | | |
| 16 | 20 | 2,5 | M 30x2 | G ¾ A | 32 | 70 | 34 | 29 | 16 | 3 | 36 | M2BW 16 G | | |
| 20 | 25 | 2,5 | M 36x2 | G 1 A | 39 | 89 | 48 | 36 | 18 | 3 | 46 | M2BW 20 G | | |
| 25 | 30 | 3 | M 42x2 | G 1 ¼ A | 49 | 98 | 54 | 34 | 20 | 3 | 50 | M2BW 25 G | | |
| 32 | 38 | 3,5 | M 52x2 | G 1 ½ A | 55 | 112 | 62 | 40 | 22 | 3 | 60 | M2BW 32 G | | |
| 40 | 44 | 4,25 | M 56x2 | G 1 ¾ A | 62 | 123 | 68 | 44 | 24 | 3,5 | 65 | M2BW 40 G | | |
| 50 | 57 | 6 | M 68x2 | G 2 A | 68 | 140 | 80 | 56 | 24 | 3,5 | 80 | M2BW 50 G | | |

M3BW-G Series for pressures up to PN 320:

| DN | d ₁ | s | d ₃ | d ₄ | d ₇ | L ₃ | l ₃ | l ₅ | i ₂ | a ₂ | s ₃ | Order number | Material number | |
|-----|----------------|------|----------------|----------------|----------------|----------------|----------------|----------------|----------------|----------------|----------------|--------------|-----------------|--------|
| | | | | | | | | | | | | | 1.0460 | 1.4571 |
| 3 | 6 | 1,5 | M 14x1,5 | G ¼ A | 18 | 48 | 23 | 14 | 12 | 2 | 19 | M3BW 3 G | | |
| 4 | 8 | 2 | M 16x1,5 | G ¼ A | 18 | 52 | 27 | 19 | 12 | 2 | 22 | M3BW 4 G | | |
| 5 | 10 | 2,5 | M 18x1,5 | G 3/8 A | 22 | 52 | 27 | 19 | 12 | 2,5 | 24 | M3BW 5 G | | |
| 6 | 12 | 3 | M 20x1,5 | G 3/8 A | 22 | 59 | 30 | 21 | 12 | 2,5 | 27 | M3BW 6 G | | |
| 8 | 13,5 | 2,75 | M 22x1,5 | G ½ A | 26 | 63 | 32 | 21 | 14 | 3 | 30 | M3BW 8 G | | |
| 10 | 16 | 3 | M 24x1,5 | G ½ A | 26 | 68 | 33 | 25 | 14 | 3 | 32 | M3BW 10 G | | |
| 12 | 20 | 4 | M 30x2 | G ¾ A | 32 | 74 | 35 | 29 | 16 | 3 | 36 | M3BW 12 G | | |
| 16 | 25 | 4,5 | M 36x2 | G 1 A | 39 | 92 | 49 | 36 | 18 | 3 | 46 | M3BW 16 G | | |
| 20 | 30 | 5 | M 42x2 | G 1 ¼ A | 49 | 104 | 56 | 34 | 20 | 3 | 50 | M3BW 20 G | | |
| 25a | 35 | 5,5 | M 48x2 | G 1 ½ A | 55 | 112 | 61 | 37 | 22 | 3 | 55 | M3BW 25a G | | |
| 25 | 38 | 6 | M 52x2 | G 1 ½ A | 55 | 118 | 64 | 40 | 22 | 3 | 60 | M3BW 25 G | | |
| 32 | 44 | 6,75 | M 60x2 | G 1 ¾ A | 62 | 134 | 73 | 47 | 24 | 3,5 | 70 | M3BW 32 G | | |

For orders on individual parts we need the following information:

| Pieces | Component | Designation | Order number | Material number |
|--------|-----------|----------------|-------------------|-----------------|
| 1 | 1 | Weld-on stub | (Series)-(DN)- 1 | _____ |
| 1 | 2 | Clamping nut | (Series)-(DN)- 2 | _____ |
| 1 | 12 | Screw-in angle | (Series)-(DN)- 12 | _____ |

Materials: see „Material standards“ page 6

Accessories: copper seals
see page 66

